

# FACILITIES OUTAGES FOR SUMMER 2018

## OVERVIEW

As part of their ongoing maintenance program, during the 2018 Summer Down Facilities Management will be powering down the transformers on-site to test them. Although this work will be conducted at night, there will be power outages to the A/B/C End Station complex that will have implications for electronics, HVAC systems and any energized equipment

that is not supported by a generator. Facilities has asked to perform this work as early as possible in order to minimize conflicts later in the summer. The following is a listing of the planned outages, their proposed dates and the impact that they will have on the halls.

## OUTAGE I: JEFFERSON LAB CAMPUS OUTAGE

**Start:** Tuesday, May 8, 2018 5:00 PM  
**Duration:** 8 Hours

### Impacts

This outage will disrupt power to ALL of CEBAF Center, the Experimental Equipment Lab (EEL), and the TED Building. Additionally, LCW water to the Test Lab will also be

disrupted. Generator power will continue to maintain the networking, core computing and telephone services, but staff should not remain in any of these buildings after they are powered off.

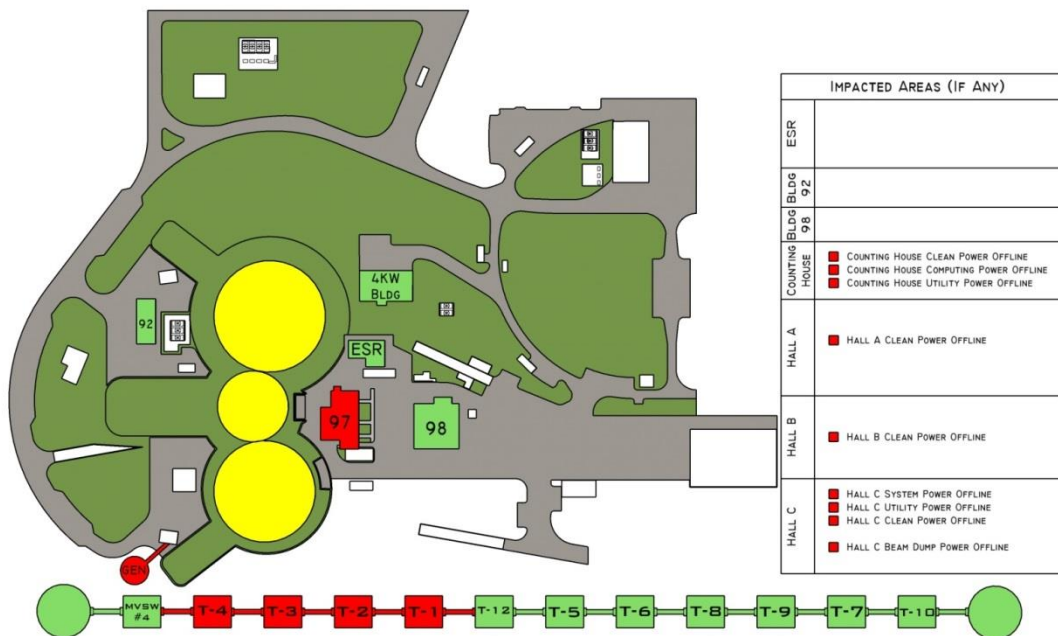

## OUTAGE II: SUB-STATIONS T-1 TO T-4

**Start:** Thursday, May 17, 2018 5:00 PM  
**Duration:** 8 Hours

### Impacts

As shown in the figure above, this outage will have a significant impact on the Counting House and Hall C, while Halls A and B will only lose clean power.

In the past a generator has been provided to power the circulating pump for Hall C's aluminum beam dump. Since this outage will be less than 48 hours, it is unnecessary to install a generator for this event.

Several generator backed receptacles are available in each of the Computer Rooms in the Counting House. Where necessary, technical staff should switch essential systems to generator backed outlets.

Power should be restored to all areas by 2:00 AM. Affected systems may be powered up immediately after this, or at the beginning of the next shift, at the discretion of the system owners.

## OUTAGE III: SWITCHBOARD MDP-TA BREAKER MAINTENANCE

Start: Friday, May 18, 2018 11:00 AM  
 Stage 1 End: Monday, May 21, 2018 1:00 PM  
 Stage 2 End: Thursday, May 31, 2018 5:00 PM

### ■ Description

This is an incremental, multiday outage where all breakers installed in Switchboard MDP-TA will be removed, maintained and then reinstalled. It will coincide with a required outage to the ESR which is fed from the same upstream breaker.

In order to minimize impact, the work will be done in two parts. On the first day (a Friday), the major upstream breaker, along with the lighting panel breakers and the HVAC breakers will be removed and sent for maintenance and testing over the weekend. The following Monday, all of these

breakers will be reinstalled, after which lighting and cooling will be restored to Hall A. Over the next two weeks, the other breakers (mostly welding outlets) will be removed and be sent for testing and maintenance. There will be a brief early morning outage of the lights and HVAC system each time another set of breakers is removed or replaced.

### ■ Impacts

Because the HVAC systems will be offline, during the first weekend of this outage Hall A will have to shutdown all non-essential. The concrete walls of the Hall will dissipate a small number of essential systems. After this initial outage, a number of short secondary outages will occur over the course of the next two weeks.

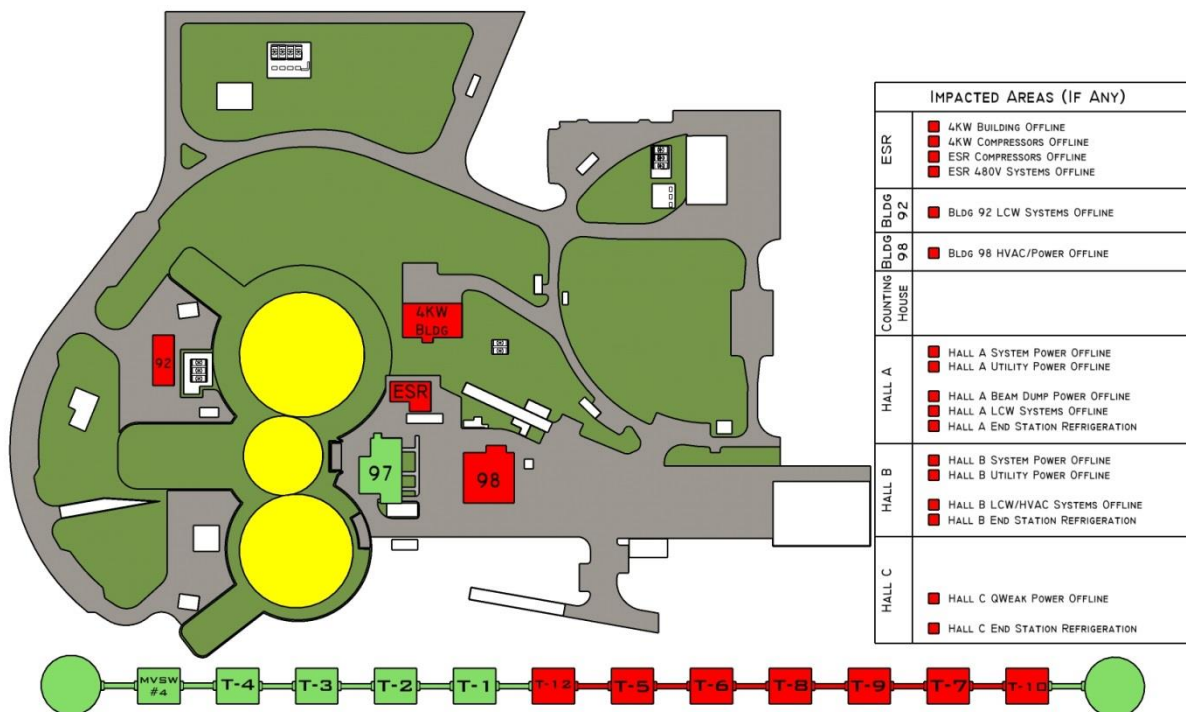

## OUTAGE IV: SUB-STATIONS T-5 TO T-12

Start: Tuesday, May 22, 2018 5:00 PM  
 Duration: 8 Hours

### ■ Impacts

As the figure illustrates, this outage will

- disable End Station Refrigeration for all three Halls,
- disrupt LCW service to all halls,
- disrupt HVAC and electrical service to the Physics Chalet,
- disrupt all power (except Clean power) to Hall A,
- disrupt all power (except Clean power) to Hall B,
- disrupt QWeak power to Hall C.

If this outage were to exceed 48 hours, generators would be provided to support the LCW system and to maintain water flow through the Hall A and Hall C aluminum beam dumps. Because of the short duration of this outage, these generators will be unnecessary.

Power should be restored to all areas by 2:00 AM. Affected systems may be powered up immediately after this, or at the beginning of the next shift, at the discretion of the system owners.

**OUTAGE V: EXPERIMENTAL STAGING BUILDING**

---

*Start:* Tuesday, June 25, 2018 5:00 PM  
*Duration:* 8 Hours

Power should be restored to all areas by 2:00 AM. Affected systems may be powered up immediately after this, or at the beginning of the next shift, at the discretion of the system owners.

**■ Impacts**

This outage will disrupt all power and cooling to the Experimental Staging Building.

**OUTAGE VI: TEST LAB POWER AND EEL CHILLED WATER OUTAGE**

---

*Start:* To Be Determined  
*Duration:* 8 Hours

Power should be restored to all areas by 2:00 AM. Affected systems may be powered up immediately after this, or at the beginning of the next shift, at the discretion of the system owners.

**■ Impacts**

This outage will disrupt all power and cooling to the Test Lab. Because the clean rooms in the EEL are serviced by the chilled water system in the basement of the Test Lab, they will also lose cooling and dehumidification. All activities that are being performed in those clean rooms should be secured and powered down prior to the outage, in order to prevent the accumulation of heat resulting in damage to the equipment.

**Contact**

---

For additional information, contact:

**Walt Akers**  
akers@jlab.org  
757/269-7669